

CITY OF MURRAY CONTROL MONUMENT CARD

DESIGNATION: MFST3 GPS
TYPE: CONCRETE MONUMENT W/ CITY DISK
DATE SET: QUAD: DEXTER, KY.
HORIZONTAL DATUM: NAD-83 VERTICAL DATUM: NAVD-88
STATE: KENTUCKY COUNTY: CALLOWAY ZONE: KY. S 1602

NORTHING: 1758260.89 FT
EASTING: 888358.15 FT
ELEVATION: 483.72 FT (GPS)
LATITUDE: N 36°37'44.33346" LONGITUDE: W 088°18'47.23182"
SCALE: CONVERGENCE:
PLANE AZI. TO AZI. MARK:

To Reach: From the intersection of Northwood Dr. and State Highway 641, go south along State Highway 641 for 0.15 miles to the station on the left.

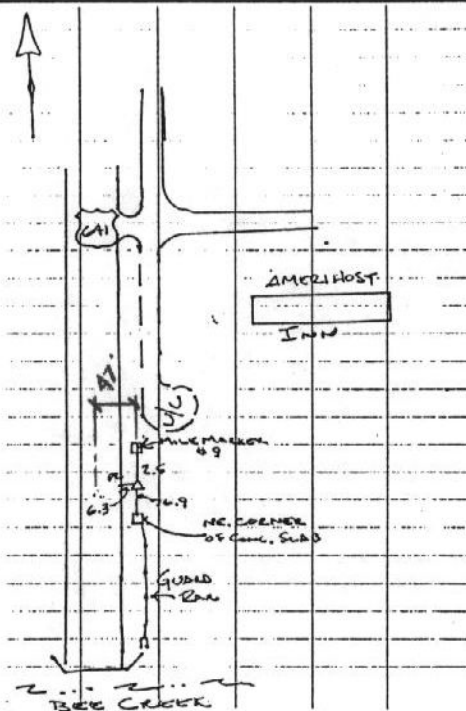

NOT TO SCALE



GRW Aerial Surveys, Inc.
801 Corporate Dr. Lexington Ky. 40503
(606)223-3999